



## Electrician's S1 round blade tom thumb slotted head screwdriver

**T-65E35**

T-...E\_Tom\_pouce

### SAM Outillage

10 rue Camille de Rochetaillée  
42000 Saint-Etienne - France

RCS Saint-Etienne B 338 002 231 | SAS au capital de 8 189 583 €

<https://www.sam-outillage.com/>

Photos and texts not contractually binding. Do not litter. Document generated on 2024-04-20 03:54:04





## DESCRIPTION



### Electrician's S1 round blade tom thumb slotted head screwdriver

Long life: Anti-corrosion coating. Performance: Blade made of chrome-molybdenum-vanadium steel ensuring a better performance in terms of bending and torsion. Ergonomic: Two-material handle suitable for 4 types of grip. Practical: Easy to hang on any support. Comfort: Round, smooth tip fitting perfectly into the palm of your hand. Perfect grip

Allows access to screws where there is very little clearance.

Chrome-plated blade with burnished tip.

The end of the blade is milled for easy access to the screw, especially in connecting blocks.

Ergonomic bi-material handle.

#### SAM Outillage

10 rue Camille de Rochetaillée  
42000 Saint-Etienne - France

RCS Saint-Etienne B 338 002 231 | SAS au capital de 8 189 583 €

<https://www.sam-outillage.com/>



Immediate identification of the slotted tip thanks to the yellow colour on the handle.

**SPECIFIC DATA**

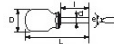

Designation	SCREWDRIVER BI-MATERIAL S1 SLOTTED ELECTRICIAN 65X35
Sales reference	T-65E35
L (mm)	91.5
Weight (g)	48
l (mm)	35
d (mm)	6.5
e (mm)	1.2
D (mm)	28
Pattern mm	6.5
Guarantee	O

**Guarantee applied**

**O | SAM TOOL guarantee.**

Guarantee without time limit on the tools used under normal conditions.

[>> Find out more](#)

**SAM Outillage**

10 rue Camille de Rochetaillée  
 42000 Saint-Etienne - France

RCS Saint-Etienne B 338 002 231 | SAS au capital de 8 189 583 €

<https://www.sam-outillage.com/>

