



Electrician's S1 round blade tom thumb slotted head screwdriver

T-55E35

T-...E_Tom_pouce

SAM Outillage

10 rue Camille de Rochetaillée
42000 Saint-Etienne - France

RCS Saint-Etienne B 338 002 231 | SAS au capital de 8 189 583 €

<https://www.sam-outillage.com/>

Photos and texts not contractually binding. Do not litter. Document generated on 2024-04-20 09:26:29





DESCRIPTION



Electrician's S1 round blade tom thumb slotted head screwdriver

Long life: Anti-corrosion coating. Performance: Blade made of chrome-molybdenum-vanadium steel ensuring a better performance in terms of bending and torsion. Ergonomic: Two-material handle suitable for 4 types of grip. Practical: Easy to hang on any support. Comfort: Round, smooth tip fitting perfectly into the palm of your hand. Perfect grip

Allows access to screws where there is very little clearance.

Chrome-plated blade with burnished tip.

The end of the blade is milled for easy access to the screw, especially in connecting blocks.

Ergonomic bi-material handle.

SAM Outillage

10 rue Camille de Rochetaillée
42000 Saint-Etienne - France

RCS Saint-Etienne B 338 002 231 | SAS au capital de 8 189 583 €

<https://www.sam-outillage.com/>



Immediate identification of the slotted tip thanks to the yellow colour on the handle.

SPECIFIC DATA

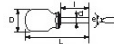

Designation	SCREWDRIVER BI-MATERIAL S1 SLOTTED ELECTRICIAN 55X35
Sales reference	T-55E35
L (mm)	91.5
Weight (g)	32
l (mm)	35
d (mm)	5.5
e (mm)	1
D (mm)	28
Pattern mm	5.5
Guarantee	O

Guarantee applied

O | SAM TOOL guarantee.

Guarantee without time limit on the tools used under normal conditions.

[>> Find out more](#)

SAM Outillage

10 rue Camille de Rochetaillée
 42000 Saint-Etienne - France

RCS Saint-Etienne B 338 002 231 | SAS au capital de 8 189 583 €

<https://www.sam-outillage.com/>

