



Phillips® S1 round blade tom thumb screwdriver

T-...P_Tom_pouce

SAM Outillage

10 rue Camille de Rochetaillée
42000 Saint-Etienne - France

RCS Saint-Etienne B 338 002 231 | SAS au capital de 8 189 583 €

<https://www.sam-outillage.com/>

Photos and texts not contractually binding. Do not litter. Document generated on 2024-04-25 08:13:44





DESCRIPTION



Phillips® S1 round blade tom thumb screwdriver

Long life: Anti-corrosion coating. Performance: Blade made of chrome-molybdenum-vanadium steel ensuring a better performance in terms of bending and torsion. Ergonomic: Two-material handle suitable for 4 types of grip. Practical: Easy to hang on any support. Comfort: Round, smooth tip fitting perfectly into the palm of your hand. Perfect grip.

Chrome-plated blade with burnished tip.

Extra-short bi-material handle for difficult access jobs.

Immediate identification of the Phillips® tip thanks to the grey colour on the handle.

STANDARDS / DIRECTIVES

SAM Outillage

10 rue Camille de Rochetaillée
42000 Saint-Etienne - France

RCS Saint-Etienne B 338 002 231 | SAS au capital de 8 189 583 €

<https://www.sam-outillage.com/>

Photos and texts not contractually binding. Do not litter. Document generated on 2024-04-25 08:13:44



NF ISO 8764-2, NF ISO 8764-1

SPECIFIC DATA

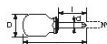

Sales reference	L (mm)	Weight (g)	l (mm)	d (mm)	D (mm)	Pattern	Guarantee
T-2P35	91.5	32	35	6	28	NÂ° 2	O
T-1P35	91.5	38	35	5	28	NÂ° 1	O
T-1P25	81.5	32	25	5	28	NÂ° 1	O

Guarantee applied

O | SAM TOOL guarantee.

Guarantee without time limit on the tools used under normal conditions.

>> [Find out more](#)

SAM Outillage

10 rue Camille de Rochetaillée
42000 Saint-Etienne - France

RCS Saint-Etienne B 338 002 231 | SAS au capital de 8 189 583 €

<https://www.sam-outillage.com/>

