



1/2" sockets for Torx® head

STX-24

STX-...

SAM Outillage

10 rue Camille de Rochetaillée
42000 Saint-Etienne - France

RCS Saint-Etienne B 338 002 231 | SAS au capital de 8 189 583 €

<https://www.sam-outillage.com/>

Photos and texts not contractually binding. Do not litter. Document generated on 2024-05-27 18:42:19





DESCRIPTION

1/2" sockets for Torx® head

For male TORX screw.

STANDARDS / DIRECTIVES

NF ISO 1174-1, NF ISO 1711-1, NF ISO 2725-1, NF EN ISO 10664

SPECIFIC DATA

SAM Outillage

10 rue Camille de Rochetaillée
42000 Saint-Etienne - France

RCS Saint-Etienne B 338 002 231 | SAS au capital de 8 189 583 €

<https://www.sam-outillage.com/>

Photos and texts not contractually binding. Do not litter. Document generated on 2024-05-27 18:42:19



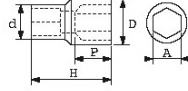

Designation	SOCKET 1/2" TORX 24
Sales reference	STX-24
Weight (g)	128
H (mm)	40.20
d (mm)	25
D (mm)	26.50
P (mm)	17.5
Pattern	N° 24
Guarantee	O

Guarantee applied

O | SAM TOOL guarantee.

Guarantee without time limit on the tools used under normal conditions.

[>> Find out more](#)

SAM Outillage

10 rue Camille de Rochetaillée
42000 Saint-Etienne - France

RCS Saint-Etienne B 338 002 231 | SAS au capital de 8 189 583 €

<https://www.sam-outillage.com/>

Photos and texts not contractually binding. Do not litter. Document generated on 2024-05-27 18:42:19

