



## 1/2" sockets for Torx® head

**STX-12**

STX-...

### SAM Outillage

10 rue Camille de Rochetaillée  
42000 Saint-Etienne - France

RCS Saint-Etienne B 338 002 231 | SAS au capital de 8 189 583 €

<https://www.sam-outillage.com/>

Photos and texts not contractually binding. Do not litter. Document generated on 2024-05-27 18:26:30





## DESCRIPTION

---

### 1/2" sockets for Torx® head

For male TORX screw.

## STANDARDS / DIRECTIVES

---

NF ISO 1174-1, NF ISO 1711-1, NF ISO 2725-1, NF EN ISO 10664

## SPECIFIC DATA

---

### SAM Outillage

10 rue Camille de Rochetaillée  
42000 Saint-Etienne - France

RCS Saint-Etienne B 338 002 231 | SAS au capital de 8 189 583 €

<https://www.sam-outillage.com/>

Photos and texts not contractually binding. Do not litter. Document generated on 2024-05-27 18:26:30



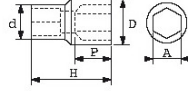

Designation	SOCKET 1/2" TORX 12
Sales reference	STX-12
Weight (g)	50
H (mm)	37
d (mm)	14
D (mm)	21
P (mm)	10
Pattern	N° 12
Guarantee	O

**Guarantee applied**

**O | SAM TOOL guarantee.**

Guarantee without time limit on the tools used under normal conditions.

[>> Find out more](#)

**SAM Outillage**

10 rue Camille de Rochetaillée  
42000 Saint-Etienne - France

RCS Saint-Etienne B 338 002 231 | SAS au capital de 8 189 583 €

<https://www.sam-outillage.com/>

Photos and texts not contractually binding. Do not litter. Document generated on 2024-05-27 18:26:30

