



## 1/2" sockets for Torx® head

**STX-10**

STX-...

### SAM Outillage

10 rue Camille de Rochetaillée  
42000 Saint-Etienne - France

RCS Saint-Etienne B 338 002 231 | SAS au capital de 8 189 583 €

<https://www.sam-outillage.com/>

Photos and texts not contractually binding. Do not litter. Document generated on 2024-04-28 04:30:50





## DESCRIPTION

---

### 1/2" sockets for Torx® head

For male TORX screw.

## STANDARDS / DIRECTIVES

---

NF ISO 1174-1, NF ISO 1711-1, NF ISO 2725-1, NF EN ISO 10664

## SPECIFIC DATA

---

### SAM Outillage

10 rue Camille de Rochetaillée  
42000 Saint-Etienne - France

RCS Saint-Etienne B 338 002 231 | SAS au capital de 8 189 583 €

<https://www.sam-outillage.com/>

Photos and texts not contractually binding. Do not litter. Document generated on 2024-04-28 04:30:50



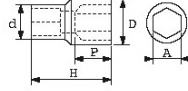

Designation	SOCKET 1/2" TORX 10
Sales reference	STX-10
Weight (g)	58
H (mm)	36
d (mm)	13.5
D (mm)	21
P (mm)	9
Pattern	N° 10
Guarantee	O

**Guarantee applied**

**O | SAM TOOL guarantee.**

Guarantee without time limit on the tools used under normal conditions.

[>> Find out more](#)

**SAM Outillage**

10 rue Camille de Rochetaillée  
42000 Saint-Etienne - France

RCS Saint-Etienne B 338 002 231 | SAS au capital de 8 189 583 €

<https://www.sam-outillage.com/>

Photos and texts not contractually binding. Do not litter. Document generated on 2024-04-28 04:30:50

