



## 1/2" short hexagonal sockets in mm

**SH-31**

SH-...

### SAM Outillage

10 rue Camille de Rochetaillée  
42000 Saint-Etienne - France

RCS Saint-Etienne B 338 002 231 | SAS au capital de 8 189 583 €

<https://www.sam-outillage.com/>

Photos and texts not contractually binding. Do not litter. Document generated on 2024-04-28 22:43:13





## DESCRIPTION

### 1/2" short hexagonal sockets in mm

Forged from chrome vanadium steel.

Bright, polished chrome-plated finish.

SAM Surface Drive profile.

## STANDARDS / DIRECTIVES

NF ISO 1174-1, NF ISO 1711-1, NF ISO 2725-1

## SAM Outillage

10 rue Camille de Rochetaillée  
42000 Saint-Etienne - France

RCS Saint-Etienne B 338 002 231 | SAS au capital de 8 189 583 €

<https://www.sam-outillage.com/>

Photos and texts not contractually binding. Do not litter. Document generated on 2024-04-28 22:43:13



**SPECIFIC DATA**

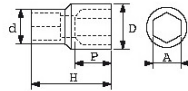

Designation	SOCKET 1/2" 6-FLAT 31 MM
Sales reference	SH-31
Weight (g)	224
H (mm)	45
d (mm)	33
D (mm)	41.6
P (mm)	20
A (mm)	31
Guarantee	O

**Guarantee applied**

**O | SAM TOOL guarantee.**

Guarantee without time limit on the tools used under normal conditions.

[>> Find out more](#)

**SAM Outillage**

10 rue Camille de Rochetaillée  
42000 Saint-Etienne - France

RCS Saint-Etienne B 338 002 231 | SAS au capital de 8 189 583 €

<https://www.sam-outillage.com/>

Photos and texts not contractually binding. Do not litter. Document generated on 2024-04-28 22:43:13

