



1/2" short hexagonal sockets in mm

SH-29

SH-...

SAM Outillage

10 rue Camille de Rochetaillée
42000 Saint-Etienne - France

RCS Saint-Etienne B 338 002 231 | SAS au capital de 8 189 583 €

<https://www.sam-outillage.com/>

Photos and texts not contractually binding. Do not litter. Document generated on 2024-04-26 05:25:00





DESCRIPTION

1/2" short hexagonal sockets in mm

Forged from chrome vanadium steel.

Bright, polished chrome-plated finish.

SAM Surface Drive profile.

STANDARDS / DIRECTIVES

NF ISO 1174-1, NF ISO 1711-1, NF ISO 2725-1

SAM Outillage

10 rue Camille de Rochetaillée
42000 Saint-Etienne - France

RCS Saint-Etienne B 338 002 231 | SAS au capital de 8 189 583 €

<https://www.sam-outillage.com/>

Photos and texts not contractually binding. Do not litter. Document generated on 2024-04-26 05:25:00

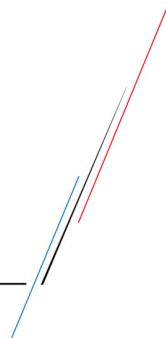

SPECIFIC DATA

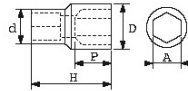

Designation	SOCKET 1/2" 6-FLAT 29 MM
Sales reference	SH-29
Weight (g)	154
H (mm)	45
d (mm)	31
D (mm)	39.1
P (mm)	18
A (mm)	29
Guarantee	O

Guarantee applied

O | SAM TOOL guarantee.

Guarantee without time limit on the tools used under normal conditions.

[>> Find out more](#)

SAM Outillage

10 rue Camille de Rochetaillée
42000 Saint-Etienne - France

RCS Saint-Etienne B 338 002 231 | SAS au capital de 8 189 583 €

<https://www.sam-outillage.com/>

Photos and texts not contractually binding. Do not litter. Document generated on 2024-04-26 05:25:00

