



## 1/2" short hexagonal sockets in mm

**SH-24**

SH-...

### SAM Outillage

10 rue Camille de Rochetaillée  
42000 Saint-Etienne - France

RCS Saint-Etienne B 338 002 231 | SAS au capital de 8 189 583 €

<https://www.sam-outillage.com/>

Photos and texts not contractually binding. Do not litter. Document generated on 2024-04-26 06:03:53





## DESCRIPTION

### 1/2" short hexagonal sockets in mm

Forged from chrome vanadium steel.

Bright, polished chrome-plated finish.

SAM Surface Drive profile.

## STANDARDS / DIRECTIVES

NF ISO 1174-1, NF ISO 1711-1, NF ISO 2725-1

## SAM Outillage

10 rue Camille de Rochetaillée  
42000 Saint-Etienne - France

RCS Saint-Etienne B 338 002 231 | SAS au capital de 8 189 583 €

<https://www.sam-outillage.com/>

Photos and texts not contractually binding. Do not litter. Document generated on 2024-04-26 06:03:53



SPECIFIC DATA

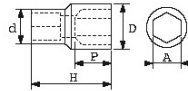

Designation	SOCKET 1/2" 6-FLAT 24 MM
Sales reference	SH-24
Weight (g)	116
H (mm)	40
d (mm)	28
D (mm)	32.9
P (mm)	16
A (mm)	24
Guarantee	O

**Guarantee applied**

**O | SAM TOOL guarantee.**

Guarantee without time limit on the tools used under normal conditions.

[>> Find out more](#)

**SAM Outillage**

10 rue Camille de Rochetaillée  
42000 Saint-Etienne - France

RCS Saint-Etienne B 338 002 231 | SAS au capital de 8 189 583 €

<https://www.sam-outillage.com/>

Photos and texts not contractually binding. Do not litter. Document generated on 2024-04-26 06:03:53

