



## 1/2" short hexagonal sockets in mm

**SAH-21**

SAH-...

### SAM Outillage

10 rue Camille de Rochetaillée  
42000 Saint-Etienne - France

RCS Saint-Etienne B 338 002 231 | SAS au capital de 8 189 583 €

<https://www.sam-outillage.com/>

Photos and texts not contractually binding. Do not litter. Document generated on 2024-04-30 15:14:36





#### DESCRIPTION

### 1/2" short hexagonal sockets in mm

Forged chrome-vanadium steel. Satin polished chrome-plate finish. SAM Surface Drive profile.

#### STANDARDS / DIRECTIVES

NF ISO 1711-1, NF ISO 2725-1, DIN 899, DIN 3124

#### SPECIFIC DATA

#### SAM Outillage

10 rue Camille de Rochetaillée  
42000 Saint-Etienne - France

RCS Saint-Etienne B 338 002 231 | SAS au capital de 8 189 583 €

<https://www.sam-outillage.com/>

Photos and texts not contractually binding. Do not litter. Document generated on 2024-04-30 15:14:36



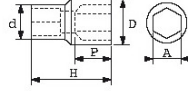

Designation	SOCKET 1/2" 6-FLAT 21 MM
Sales reference	SAH-21
Weight (g)	95
H (mm)	38
d (mm)	26
D (mm)	29
P (mm)	12
A (mm)	21
Guarantee	O

**Guarantee applied**

**O | SAM TOOL guarantee.**

Guarantee without time limit on the tools used under normal conditions.

>> [Find out more](#)

**SAM Outillage**

10 rue Camille de Rochetaillée  
42000 Saint-Etienne - France

RCS Saint-Etienne B 338 002 231 | SAS au capital de 8 189 583 €

<https://www.sam-outillage.com/>

Photos and texts not contractually binding. Do not litter. Document generated on 2024-04-30 15:14:36

