



1/2" short hexagonal sockets in mm

SAH-11

SAH-...

SAM Outillage

10 rue Camille de Rochetaillée
42000 Saint-Etienne - France

RCS Saint-Etienne B 338 002 231 | SAS au capital de 8 189 583 €

<https://www.sam-outillage.com/>

Photos and texts not contractually binding. Do not litter. Document generated on 2024-04-30 22:24:20





DESCRIPTION

1/2" short hexagonal sockets in mm

Forged chrome-vanadium steel. Satin polished chrome-plate finish. SAM Surface Drive profile.

STANDARDS / DIRECTIVES

NF ISO 1711-1, NF ISO 2725-1, DIN 899, DIN 3124

SPECIFIC DATA

SAM Outillage

10 rue Camille de Rochetaillée
42000 Saint-Etienne - France

RCS Saint-Etienne B 338 002 231 | SAS au capital de 8 189 583 €

<https://www.sam-outillage.com/>

Photos and texts not contractually binding. Do not litter. Document generated on 2024-04-30 22:24:20



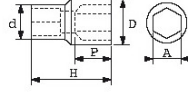

Designation	SOCKET 1/2" 6-FLAT 11 MM
Sales reference	SAH-11
Weight (g)	60
H (mm)	38
d (mm)	22.2
D (mm)	16.6
P (mm)	7
A (mm)	11
Guarantee	O

Guarantee applied

O | SAM TOOL guarantee.

Guarantee without time limit on the tools used under normal conditions.

[>> Find out more](#)

SAM Outillage

10 rue Camille de Rochetaillée
42000 Saint-Etienne - France

RCS Saint-Etienne B 338 002 231 | SAS au capital de 8 189 583 €

<https://www.sam-outillage.com/>

Photos and texts not contractually binding. Do not litter. Document generated on 2024-04-30 22:24:20

