



1"1/2" short impacts sockets

NG-...

SAM Outillage

10 rue Camille de Rochetaillée
42000 Saint-Etienne - France

RCS Saint-Etienne B 338 002 231 | SAS au capital de 8 189 583 €

<https://www.sam-outillage.com/>

Photos and texts not contractually binding. Do not litter. Document generated on 2024-05-03 10:04:40





DESCRIPTION

1"1/2" short impacts sockets

Sockets designed to withstand the forces transmitted by impact machines. (power screwdriver, electrical or pneumatic impact wrenches) used in industry or the automotive sector.

Locking by pin and locking ring.

Very good resistance to wear.

Burnished finish.

STANDARDS / DIRECTIVES

NF ISO 1711-1, NF ISO 1174-2, NF ISO 2725-2

SAM Outillage

10 rue Camille de Rochetaillée
42000 Saint-Etienne - France

RCS Saint-Etienne B 338 002 231 | SAS au capital de 8 189 583 €

<https://www.sam-outillage.com/>

Photos and texts not contractually binding. Do not litter. Document generated on 2024-05-03 10:04:40



SPECIFIC DATA

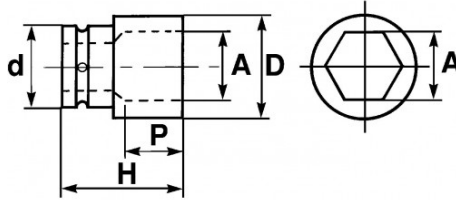

Sales reference	Weight (g)	H (mm)	d (mm)	D (mm)	P (mm)	A (mm)	Guarantee
NG-100	7400	125	127	140	54	100	O
NG-105	8000	129	127	150	54	105	O
NG-110	9400	135	127	155	62	110	O
NG-115	10500	139	127	160	57	115	O
NG-120	12500	143	127	165	67	120	O
NG-46	2200	89	86	75	25.50	46	O
NG-50 (not marketed)	2600	89	86	80	23.50	50	O
NG-55 (not marketed)	2800	92	86	86	30	55	O
NG-60 (not marketed)	3100	92	86	92	28	60	O
NG-65	3400	97	86	100	35	65	O

SAM Outillage

10 rue Camille de Rochetaillée
42000 Saint-Etienne - France

RCS Saint-Etienne B 338 002 231 | SAS au capital de 8 189 583 €

<https://www.sam-outillage.com/>

Photos and texts not contractually binding. Do not litter. Document generated on 2024-05-03 10:04:40



NG-70	3800	101	86	105	38	70	O
NG-75	3660	107	86	109	41	75	O
NG-80	4800	111	86	115	37	80	O
NG-85	5200	113	86	121	40	85	O
NG-90	5800	116	86	130	43	90	O
NG-95	6500	120	127	135	49	95	O

Guarantee applied

O | SAM TOOL guarantee.

Guarantee without time limit on the tools used under normal conditions.

[>> Find out more](#)

SAM Outillage

10 rue Camille de Rochetaillée
42000 Saint-Etienne - France

RCS Saint-Etienne B 338 002 231 | SAS au capital de 8 189 583 €

<https://www.sam-outillage.com/>

Photos and texts not contractually binding. Do not litter. Document generated on 2024-05-03 10:04:40

