



3/4" impact adapter

NC-232

SAM Outillage

10 rue Camille de Rochetaillée
42000 Saint-Etienne - France

RCS Saint-Etienne B 338 002 231 | SAS au capital de 8 189 583 €

<https://www.sam-outillage.com/>

Photos and texts not contractually binding. Do not litter. Document generated on 2024-05-07 00:06:18



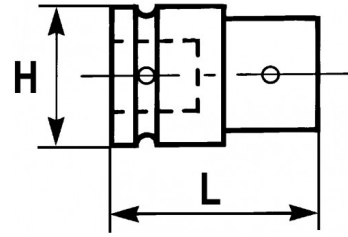

DESCRIPTION

3/4" impact adapter

Female square 3/4" ---> male square 1".For using 1" impact sockets.

STANDARDS / DIRECTIVES

NF ISO 1174-1

SAM Outillage

10 rue Camille de Rochetaillée
42000 Saint-Etienne - France

RCS Saint-Etienne B 338 002 231 | SAS au capital de 8 189 583 €

<https://www.sam-outillage.com/>

Photos and texts not contractually binding. Do not litter. Document generated on 2024-05-07 00:06:18



SPECIFIC DATA

Designation	NC232 IMPACT ADAPTOR 3/4"
Sales reference	NC-232
L (mm)	60
Weight (g)	440
H (mm)	44
Guarantee	O SAM TOOL guarantee.

Guarantee applied**O | SAM TOOL guarantee.**

Guarantee without time limit on the tools used under normal conditions.

[>> Find out more](#)**SAM Outillage**10 rue Camille de Rochetaillée
42000 Saint-Etienne - France

RCS Saint-Etienne B 338 002 231 | SAS au capital de 8 189 583 €

<https://www.sam-outillage.com/>