



Compact torque multiplier

ML-150

SAM Outillage

10 rue Camille de Rochetaillée
42000 Saint-Etienne - France

RCS Saint-Etienne B 338 002 231 | SAS au capital de 8 189 583 €

<https://www.sam-outillage.com/>

Photos and texts not contractually binding. Do not litter. Document generated on 2024-04-25 22:01:12





DESCRIPTION

Compact torque multiplier

PRECISION GUARANTEED: +/- 4% with the SAM torque multipliers.**UTILISATION SAFETY:** replaces extensions and handmade long levers.**IMPOSSIBLE TO OVERSHOOT THE TORQUE VALUE:** thanks to the torque limiting mechanism.**COMPACT:** enables use in confined spaces.**SAFETY:** supplied with a fulcrum system for safety.

Ideal for tightening and loosening very high torque values. Constant multiplication factor of x5. Handy thanks to its small size allowing it to be used in places with not much clearance. Supplied with a flat support point. Supplied in a box to facilitate transport. **RECOMMENDATIONS FOR YOUR SAFETY** Given the forces generated, the use of torque multipliers requires simple, but vital, safety measures:- To be sure of controlling the output force always use a torque wrench. Never use an impact wrench type tool.- Check that the support point can withstand the output torque value.- Preferably use "impact" sockets locked with a clip and pin.- Never attempt to exceed the multiplier's indicated maximum value. You would risk breaking the pinions, with all the dangers caused by the restitution force.

STANDARDS / DIRECTIVES

SAM Outillage

10 rue Camille de Rochetaillée
42000 Saint-Etienne - France

RCS Saint-Etienne B 338 002 231 | SAS au capital de 8 189 583 €

<https://www.sam-outillage.com/>



NF ISO 1174-1

SPECIFIC DATA

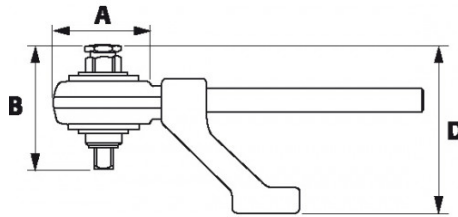

TROUQUE TIGHTENING

Designation	TORQUE MULTIPLIER X5 DIAMETER 72 MM
Sales reference	ML-150
Weight (kg)	6.46
D (mm)	180
A (mm)	108
Maximum output torque Nm	1500
Maximum output torque Ft.lb	1110
C min mm	-
C max mm	-
output square "	1"
input square "	1/2"
Maximum input torque Nm	300
B (mm)	126

SAM Outillage

10 rue Camille de Rochetaillée
42000 Saint-Etienne - France

RCS Saint-Etienne B 338 002 231 | SAS au capital de 8 189 583 €

<https://www.sam-outillage.com/>

Photos and texts not contractually binding. Do not litter. Document generated on 2024-04-25 22:01:12



Guarantee	M1 SAM Equipment and Machine Guarantee:
-----------	---

Guarantee applied

M1 | SAM Equipment and Machine Guarantee:

Guarantee for a limited period, covering technical tools, devices and machines used under normal conditions. The length is given by the number after the letter M: 1 to 5 years

[>> Find out more](#)

SAM Outillage

10 rue Camille de Rochetaillée
42000 Saint-Etienne - France

RCS Saint-Etienne B 338 002 231 | SAS au capital de 8 189 583 €

<https://www.sam-outillage.com/>

Photos and texts not contractually binding. Do not litter. Document generated on 2024-04-25 22:01:12

