

## Square double round ends 19 mm

**DC-5-3/4**  
DC-2-.../DC-5-...

---

### SAM Outillage

10 rue Camille de Rochetaillée  
42000 Saint-Etienne - France

RCS Saint-Etienne B 338 002 231 | SAS au capital de 8 189 583 €

<https://www.sam-outillage.com/>

Photos and texts not contractually binding. Do not litter. Document generated on 2024-04-26 10:58:29



**DESCRIPTION**

**Square double round ends 19 mm**

Polished chrome-plate finish. Forged chrome-vanadium steel. Utilisation with all models of SAM torque wrenches with round attachment 19 mm or 30 mm.

**STANDARDS / DIRECTIVES**

NF ISO 1174-1

**SPECIFIC DATA**

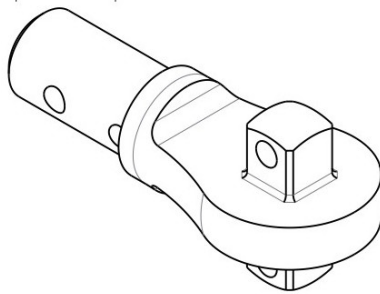

Designation	SQ DR ADAPT ROUND MALE DOUBLE SQUARE 3/4"
Sales reference	DC-5-3/4
L (mm)	154
Weight (g)	805
e1 (mm)	67
Ends	30 mm

**SAM Outillage**

10 rue Camille de Rochetaillée  
 42000 Saint-Etienne - France

RCS Saint-Etienne B 338 002 231 | SAS au capital de 8 189 583 €

<https://www.sam-outillage.com/>



square "	3/4
Guarantee	O

**Guarantee applied**

**O | SAM TOOL guarantee.**

Guarantee without time limit on the tools used under normal conditions.

[>> Find out more](#)

**SAM Outillage**

10 rue Camille de Rochetaillée  
42000 Saint-Etienne - France

RCS Saint-Etienne B 338 002 231 | SAS au capital de 8 189 583 €

<https://www.sam-outillage.com/>

Photos and texts not contractually binding. Do not litter. Document generated on 2024-04-26 10:58:29

