

Square double round ends 19 mm

DC-2-1/2
DC-2-.../DC-5-...

SAM Outillage

10 rue Camille de Rochetaillée
42000 Saint-Etienne - France

RCS Saint-Etienne B 338 002 231 | SAS au capital de 8 189 583 €

<https://www.sam-outillage.com/>

Photos and texts not contractually binding. Do not litter. Document generated on 2024-04-26 12:17:08



DESCRIPTION

Square double round ends 19 mm

Polished chrome-plate finish. Forged chrome-vanadium steel. Utilisation with all models of SAM torque wrenches with round attachment 19 mm or 30 mm.

STANDARDS / DIRECTIVES

NF ISO 1174-1

SPECIFIC DATA

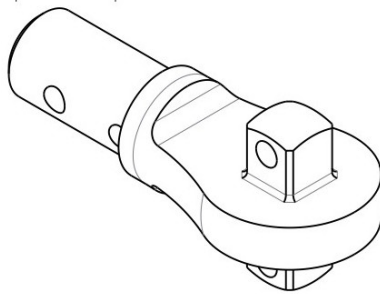

Designation	SQ DR ADAPT ROUND MALE DOUBLE SQUARE 1/2"
Sales reference	DC-2-1/2
L (mm)	80
Weight (g)	190
e1 (mm)	46
Ends	19 mm

SAM Outillage

10 rue Camille de Rochetaillée
 42000 Saint-Etienne - France

RCS Saint-Etienne B 338 002 231 | SAS au capital de 8 189 583 €

<https://www.sam-outillage.com/>



square "	1/2
Guarantee	O

Guarantee applied

O | SAM TOOL guarantee.

Guarantee without time limit on the tools used under normal conditions.

[>> Find out more](#)

TROUQUE TIGHTENING

SAM Outillage

10 rue Camille de Rochetaillée
42000 Saint-Etienne - France

RCS Saint-Etienne B 338 002 231 | SAS au capital de 8 189 583 €

<https://www.sam-outillage.com/>

Photos and texts not contractually binding. Do not litter. Document generated on 2024-04-26 12:17:08

