



Socket wrenches, 6/6-flat, in mm

94-SD25

94-SD...

SAM Outillage

10 rue Camille de Rochetaillée
42000 Saint-Etienne - France

RCS Saint-Etienne B 338 002 231 | SAS au capital de 8 189 583 €

<https://www.sam-outillage.com/>

Photos and texts not contractually binding. Do not litter. Document generated on 2024-04-28 15:51:29





DESCRIPTION

Socket wrenches, 6/6-flat, in mm

6X6-flat through box spanner, designed for powerful tightening/loosening. Through head allowing threaded rods or protruding rings to pass. Forged chrome-vanadium steel. SAM Surface Drive punching avoiding peening of the nuts. Fine shape to facilitate access to the nuts. Bright polished finish.

STANDARDS / DIRECTIVES

NF ISO 691, NF ISO 1711-1, NF ISO 2236, ISO 691, ISO 1711-1, DIN ISO 1711-1, DIN ISO 691, ISO 2236

SAM Outillage

10 rue Camille de Rochetaillée
42000 Saint-Etienne - France

RCS Saint-Etienne B 338 002 231 | SAS au capital de 8 189 583 €

<https://www.sam-outillage.com/>

Photos and texts not contractually binding. Do not litter. Document generated on 2024-04-28 15:51:29



SPECIFIC DATA

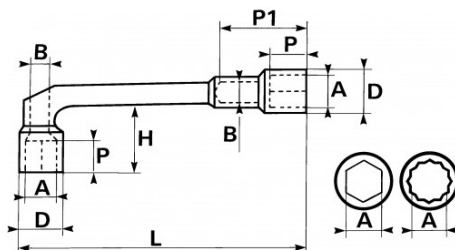

Designation	DOUBLE ENDED HOLLOW OFFSET SOCKET WRENCHES 6 POINTS 25MM
Sales reference	94-SD25
L (mm)	237
Weight (g)	570
H (mm)	57
D (mm)	34
P (mm)	26
A (mm)	25
P1 (mm)	66
B (mm)	17
Guarantee	O

Guarantee applied

O | SAM TOOL guarantee.

Guarantee without time limit on the tools used under normal conditions.

[>> Find out more](#)

SAM Outillage

10 rue Camille de Rochetaillée
42000 Saint-Etienne - France

RCS Saint-Etienne B 338 002 231 | SAS au capital de 8 189 583 €

<https://www.sam-outillage.com/>

Photos and texts not contractually binding. Do not litter. Document generated on 2024-04-28 15:51:29

