



Socket wrenches, 6/6-flat, polished finish, in mm + clip

94-SD21-FME

94-SD...-FME

SAM Outillage

10 rue Camille de Rochetaillée
42000 Saint-Etienne - France

RCS Saint-Etienne B 338 002 231 | SAS au capital de 8 189 583 €

<https://www.sam-outillage.com/>

Photos and texts not contractually binding. Do not litter. Document generated on 2024-05-03 12:54:16





DESCRIPTION

Socket wrenches, 6/6-flat, polished finish, in mm + clip

Safety: To ensure your interventions are safe, to avoid dropping tools and wasting time, to prevent industrial accidents and improve productivity = Opt for the SAM anti-dropping solution. All the products in the FME range are equipped with a clip preventing you from dropping your tools.

6X6-flat through box spanner, designed for powerful tightening/loosening. Through head allowing threaded rods or protruding rings to pass. Forged chrome-vanadium steel. SAM Surface Drive punching avoiding peening of the nuts. Fine shape to facilitate access to the nuts. Bright polished finish.

STANDARDS / DIRECTIVES

NF ISO 691, NF ISO 1711-1, NF ISO 2236, ISO 691, ISO 1711-1, DIN ISO 1711-1, ISO 2236

SAM Outillage

10 rue Camille de Rochetaillée
42000 Saint-Etienne - France

RCS Saint-Etienne B 338 002 231 | SAS au capital de 8 189 583 €

<https://www.sam-outillage.com/>

Photos and texts not contractually binding. Do not litter. Document generated on 2024-05-03 12:54:16



SPECIFIC DATA

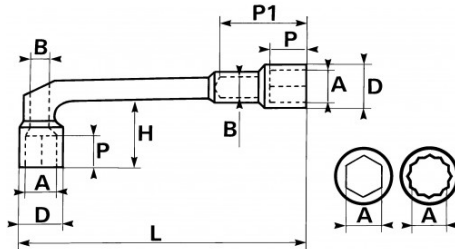

Designation	HEX/HEX HOLLOW ANGLED SOCKET WRENCH
Sales reference	94-SD21-FME
L (mm)	210
Weight (g)	410
H (mm)	48
D (mm)	29
P (mm)	22
A (mm)	21
P1 (mm)	60
B (mm)	15
Guarantee	O

Guarantee applied

O | SAM TOOL guarantee.

Guarantee without time limit on the tools used under normal conditions.

[>> Find out more](#)

SAM Outillage

10 rue Camille de Rochetaillée
42000 Saint-Etienne - France

RCS Saint-Etienne B 338 002 231 | SAS au capital de 8 189 583 €

<https://www.sam-outillage.com/>

Photos and texts not contractually binding. Do not litter. Document generated on 2024-05-03 12:54:16

