



## Hexagonal/hexagonal satin finish open socket wrenches

94-...

### SAM Outillage

10 rue Camille de Rochetaillée  
42000 Saint-Etienne - France

RCS Saint-Etienne B 338 002 231 | SAS au capital de 8 189 583 €

<https://www.sam-outillage.com/>

Photos and texts not contractually binding. Do not litter. Document generated on 2024-04-30 20:58:22





## DESCRIPTION

### Hexagonal/hexagonal satin finish open socket wrenches

6X6-flat through box spanner, designed for powerful tightening/loosening. Through head allowing threaded rods or protruding rings to pass. Forged chrome-vanadium steel. SAM Surface Drive punching avoiding peening of the nuts. Satin finish. Fine shape to facilitate access to the nuts.

## STANDARDS / DIRECTIVES

NF ISO 691, NF ISO 1711-1, NF ISO 2236, ISO 691, ISO 1711-1, DIN ISO 1711-1, DIN ISO 691, ISO 2236

### SAM Outillage

10 rue Camille de Rochetaillée  
42000 Saint-Etienne - France

RCS Saint-Etienne B 338 002 231 | SAS au capital de 8 189 583 €

<https://www.sam-outillage.com/>

Photos and texts not contractually binding. Do not litter. Document generated on 2024-04-30 20:58:22



SPECIFIC DATA

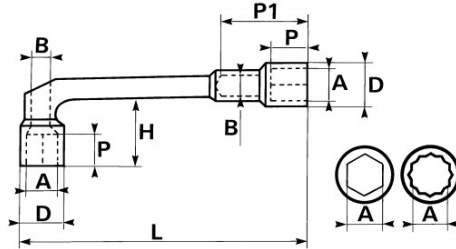

Sales reference	L (mm)	Weight (g)	H (mm)	D (mm)	P (mm)	A (mm)	P1 (mm)	B (mm)	Guarantee
94-5	86	20	13	9	6	5	15	4.5	O
94-6	97	30	17	11	8	6	23	5.5	O
94-7	97	30	17	11	8	7	23	5.5	O
94-8	119	60	22	14	10	8	28	6.5	O
94-9	119	60	22	14	10	9	28	6.5	O
94-10	133	100	25	16	11	10	34	8	O
94-11	133	90	25	16	11	11	34	8	O
94-12	144	115	30	18.5	13	12	36	9	O
94-13	144	120	30	18.5	13	13	36	9	O
94-14	165	200	34	21	15	14	43	9.5	O
94-15	165	195	34	21	15	15	43	9.5	O
94-16	187	250	38	24	17	16	52	11.5	O

**SAM Outillage**

10 rue Camille de Rochetaillée  
42000 Saint-Etienne - France

RCS Saint-Etienne B 338 002 231 | SAS au capital de 8 189 583 €

<https://www.sam-outillage.com/>



94-17	187	240	38	24	17	17	52	11.5	O
94-18	198	390	45	26.5	20	18	57	14	O
94-19	198	370	45	26.5	20	19	57	14	O
94-20	210	380	48	29	22	20	60	15	O
94-21	210	390	48	29	22	21	60	15	O
94-22	231	520	54	32	24	22	66	17	O
94-23	231	480	54	32	24	23	66	17	O
94-24	237	580	57	34	26	24	66	17	O
94-25	237	635	57	34	26	25	66	17	O
94-26	258	795	60	36.5	28	26	74	21	O
94-27	258	790	60	36.5	28	27	74	21	O
94-28	268	890	62	39.5	30	28	76	21	O
94-29	268	870	62	39.5	30	29	76	21	O
94-30	292	1150	66	41	31.5	30	83	24	O
94-31	292	1120	66	41	31.5	31	83	24	O
94-32	308	1250	68	44	33	32	83	24	O
94-5,5	86	20	13	9	6	5.5	15	4.5	O

**Guarantee applied**

**O | SAM TOOL guarantee.**

Guarantee without time limit on the tools used under normal conditions.

[>> Find out more](#)

**SAM Outillage**

10 rue Camille de Rochetaillée  
42000 Saint-Etienne - France

RCS Saint-Etienne B 338 002 231 | SAS au capital de 8 189 583 €

<https://www.sam-outillage.com/>

Photos and texts not contractually binding. Do not litter. Document generated on 2024-04-30 20:58:22

