



Through box wrenches, 6/12-flat, satin finish, in mm

93-8
93-...

SAM Outillage

10 rue Camille de Rochetaillée
42000 Saint-Etienne - France

RCS Saint-Etienne B 338 002 231 | SAS au capital de 8 189 583 €

<https://www.sam-outillage.com/>





DESCRIPTION

Through box wrenches, 6/12-flat, satin finish, in mm

Through box spanner 6x12 flats, designed for powerful tightening/loosening. 12-flat on bend side, 6-flat on long side. Through head allowing threaded rods or protruding rings to pass. Forged chrome-vanadium steel. SAM Surface Drive punching avoiding peening of the nuts. Fine shape to facilitate access to the nuts. Satin finish.

STANDARDS / DIRECTIVES

NF ISO 691, NF ISO 1711-1, NF ISO 2236, ISO 691, ISO 1711-1, DIN ISO 1711-1, DIN ISO 691, ISO 2236

SAM Outillage

10 rue Camille de Rochetaillée
42000 Saint-Etienne - France

RCS Saint-Etienne B 338 002 231 | SAS au capital de 8 189 583 €

<https://www.sam-outillage.com/>

Photos and texts not contractually binding. Do not litter. Document generated on 2024-05-05 05:54:38



SPECIFIC DATA

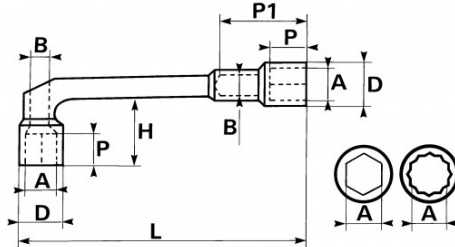

Designation	HEX/BIHEX HOLLOW ANGLED SOCKET WRENCH
Sales reference	93-8
L (mm)	119
Weight (g)	60
H (mm)	22
D (mm)	14
P (mm)	10
A (mm)	8
P1 (mm)	28
B (mm)	6.5
Guarantee	O

Guarantee applied

O | SAM TOOL guarantee.

Guarantee without time limit on the tools used under normal conditions.

[>> Find out more](#)

SAM Outillage

10 rue Camille de Rochetaillée
42000 Saint-Etienne - France

RCS Saint-Etienne B 338 002 231 | SAS au capital de 8 189 583 €

<https://www.sam-outillage.com/>

Photos and texts not contractually binding. Do not litter. Document generated on 2024-05-05 05:54:38

