



Through box wrenches, 6/12-flat, satin finish, in mm

93-28

93-...

SAM Outillage

10 rue Camille de Rochetaillée
42000 Saint-Etienne - France

RCS Saint-Etienne B 338 002 231 | SAS au capital de 8 189 583 €

<https://www.sam-outillage.com/>





DESCRIPTION

Through box wrenches, 6/12-flat, satin finish, in mm

Through box spanner 6x12 flats, designed for powerful tightening/loosening. 12-flat on bend side, 6-flat on long side. Through head allowing threaded rods or protruding rings to pass. Forged chrome-vanadium steel. SAM Surface Drive punching avoiding peening of the nuts. Fine shape to facilitate access to the nuts. Satin finish.

STANDARDS / DIRECTIVES

NF ISO 691, NF ISO 1711-1, NF ISO 2236, ISO 691, ISO 1711-1, DIN ISO 1711-1, DIN ISO 691, ISO 2236

SAM Outillage

10 rue Camille de Rochetaillée
42000 Saint-Etienne - France

RCS Saint-Etienne B 338 002 231 | SAS au capital de 8 189 583 €

<https://www.sam-outillage.com/>

Photos and texts not contractually binding. Do not litter. Document generated on 2024-05-05 09:16:19



SPECIFIC DATA

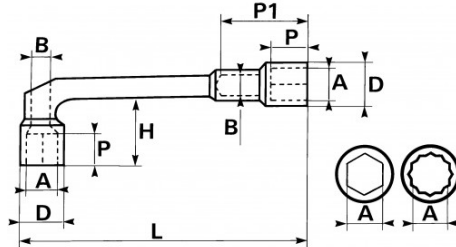

Designation	THROUGH BOX SPANNER 6/12-FLAT 28 MM
Sales reference	93-28
L (mm)	268
Weight (g)	870
H (mm)	62
D (mm)	39.5
P (mm)	30
A (mm)	28
P1 (mm)	76
B (mm)	21
Guarantee	O

Guarantee applied

O | SAM TOOL guarantee.

Guarantee without time limit on the tools used under normal conditions.

[>> Find out more](#)

SAM Outillage

10 rue Camille de Rochetaillée
42000 Saint-Etienne - France

RCS Saint-Etienne B 338 002 231 | SAS au capital de 8 189 583 €

<https://www.sam-outillage.com/>

Photos and texts not contractually binding. Do not litter. Document generated on 2024-05-05 09:16:19

