



## Through box wrenches, 6/12-flat, satin finish, in mm

**93-16**

93-...

### SAM Outillage

10 rue Camille de Rochetaillée  
42000 Saint-Etienne - France

RCS Saint-Etienne B 338 002 231 | SAS au capital de 8 189 583 €

<https://www.sam-outillage.com/>

Photos and texts not contractually binding. Do not litter. Document generated on 2024-05-05 04:27:10





## DESCRIPTION

### Through box wrenches, 6/12-flat, satin finish, in mm

Through box spanner 6x12 flats, designed for powerful tightening/loosening. 12-flat on bend side, 6-flat on long side. Through head allowing threaded rods or protruding rings to pass. Forged chrome-vanadium steel. SAM Surface Drive punching avoiding peening of the nuts. Fine shape to facilitate access to the nuts. Satin finish.

## STANDARDS / DIRECTIVES

NF ISO 691, NF ISO 1711-1, NF ISO 2236, ISO 691, ISO 1711-1, DIN ISO 1711-1, DIN ISO 691, ISO 2236

### SAM Outillage

10 rue Camille de Rochetaillée  
42000 Saint-Etienne - France

RCS Saint-Etienne B 338 002 231 | SAS au capital de 8 189 583 €

<https://www.sam-outillage.com/>

Photos and texts not contractually binding. Do not litter. Document generated on 2024-05-05 04:27:10



SPECIFIC DATA

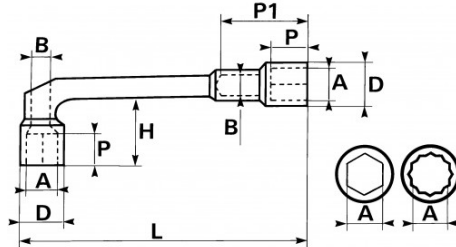

Designation	THROUGH BOX SPANNER 6/12-FLAT 16 MM
Sales reference	93-16
L (mm)	187
Weight (g)	270
H (mm)	38
D (mm)	24
P (mm)	17
A (mm)	16
P1 (mm)	52
B (mm)	11.5
Guarantee	O

**Guarantee applied**

**O | SAM TOOL guarantee.**

Guarantee without time limit on the tools used under normal conditions.

[>> Find out more](#)

**SAM Outillage**

10 rue Camille de Rochetaillée  
42000 Saint-Etienne - France

RCS Saint-Etienne B 338 002 231 | SAS au capital de 8 189 583 €

<https://www.sam-outillage.com/>

Photos and texts not contractually binding. Do not litter. Document generated on 2024-05-05 04:27:10

