



Through box wrenches, 6/12-flat, satin finish, in mm

93-...

SAM Outillage

10 rue Camille de Rochetaillée
42000 Saint-Etienne - France

RCS Saint-Etienne B 338 002 231 | SAS au capital de 8 189 583 €

<https://www.sam-outillage.com/>

Photos and texts not contractually binding. Do not litter. Document generated on 2024-05-05 06:24:15





DESCRIPTION

Through box wrenches, 6/12-flat, satin finish, in mm

Through box spanner 6x12 flats, designed for powerful tightening/loosening. 12-flat on bend side, 6-flat on long side. Through head allowing threaded rods or protruding rings to pass. Forged chrome-vanadium steel. SAM Surface Drive punching avoiding peening of the nuts. Fine shape to facilitate access to the nuts. Satin finish.

STANDARDS / DIRECTIVES

NF ISO 691, NF ISO 1711-1, NF ISO 2236, ISO 691, ISO 1711-1, DIN ISO 1711-1, DIN ISO 691, ISO 2236

SAM Outillage

10 rue Camille de Rochetaillée
42000 Saint-Etienne - France

RCS Saint-Etienne B 338 002 231 | SAS au capital de 8 189 583 €

<https://www.sam-outillage.com/>

Photos and texts not contractually binding. Do not litter. Document generated on 2024-05-05 06:24:15



SPECIFIC DATA

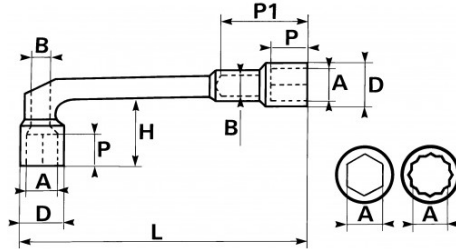

Sales reference	L (mm)	Weight (g)	H (mm)	D (mm)	P (mm)	A (mm)	P1 (mm)	B (mm)	Guarantee
93-6	97	57	17	11	8	6	23	5.5	O
93-7	97	30	17	11	8	7	23	5.5	O
93-8	119	60	22	14	10	8	28	6.5	O
93-9	119	60	22	14	10	9	28	6.5	O
93-10	133	100	25	16	11	10	34	8	O
93-11	133	100	25	16	11	11	34	8	O
93-12	144	125	30	18.5	13	12	36	9	O
93-13	144	115	30	18.5	13	13	36	9	O
93-14	165	200	34	21	15	14	43	9.5	O
93-15	165	190	34	21	15	15	43	9.5	O
93-16	187	270	38	24	17	16	52	11.5	O
93-17	187	250	38	24	17	17	52	11.5	O

SAM Outillage

10 rue Camille de Rochetaillée
42000 Saint-Etienne - France

RCS Saint-Etienne B 338 002 231 | SAS au capital de 8 189 583 €

<https://www.sam-outillage.com/>



93-18	198	365	45	26.5	20	18	57	14	O
93-19	198	365	45	26.5	20	19	57	14	O
93-20	210	390	48	29	22	20	60	15	O
93-21	210	395	48	29	22	21	60	15	O
93-22	231	500	54	32	24	22	66	17	O
93-23	231	485	54	32	24	23	66	17	O
93-24	237	520	57	34	26	24	66	17	O
93-25	237	635	57	34	26	25	66	17	O
93-26	258	790	60	36.5	28	26	74	21	O
93-27	258	740	60	36.5	28	27	74	21	O
93-28	268	870	62	39.5	30	28	76	21	O
93-29	268	820	62	39.5	30	29	76	21	O
93-30	292	1050	66	41	31.5	30	83	24	O
93-31	292	1120	66	41	31.5	31	83	24	O
93-32	308	1250	68	44	33	32	83	24	O

Guarantee applied

O | SAM TOOL guarantee.

Guarantee without time limit on the tools used under normal conditions.

>> [Find out more](#)

SAM Outillage

10 rue Camille de Rochetaillée
42000 Saint-Etienne - France

RCS Saint-Etienne B 338 002 231 | SAS au capital de 8 189 583 €

<https://www.sam-outillage.com/>

Photos and texts not contractually binding. Do not litter. Document generated on 2024-05-05 06:24:15

