



Open wrenches in mm for micro-mechanics

35-7
35-...

SAM Outillage

10 rue Camille de Rochetaillée
42000 Saint-Etienne - France

RCS Saint-Etienne B 338 002 231 | SAS au capital de 8 189 583 €

<https://www.sam-outillage.com/>

Photos and texts not contractually binding. Do not litter. Document generated on 2024-05-01 20:01:49





DESCRIPTION

Open wrenches in mm for micro-mechanics

2 heads of same opening, with 15 et 75°arc swing

a short handle and thin heads facilitate the delicate work for micro-mechanics, where the access to the nuts is difficult

STANDARDS / DIRECTIVES

NF ISO 691, NF ISO 3318

SAM Outillage

10 rue Camille de Rochetaillée
42000 Saint-Etienne - France

RCS Saint-Etienne B 338 002 231 | SAS au capital de 8 189 583 €

<https://www.sam-outillage.com/>

Photos and texts not contractually binding. Do not litter. Document generated on 2024-05-01 20:01:49



SPECIFIC DATA

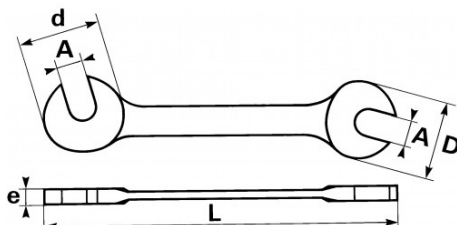

Designation	OFFSET O/E WRENCH OPEN MICRO MECHANICAL 7MM
Sales reference	35-7
L (mm)	80
Weight (g)	11
d (mm)	15
e (mm)	2.7
D (mm)	15
A (mm)	7
Guarantee	O

Guarantee applied

O | SAM TOOL guarantee.

Guarantee without time limit on the tools used under normal conditions.

[>> Find out more](#)

SAM Outillage

10 rue Camille de Rochetaillée
42000 Saint-Etienne - France

RCS Saint-Etienne B 338 002 231 | SAS au capital de 8 189 583 €

<https://www.sam-outillage.com/>

Photos and texts not contractually binding. Do not litter. Document generated on 2024-05-01 20:01:49

