



## Open wrenches in mm for micro-mechanics

**35-5,5**  
35-...

### SAM Outillage

10 rue Camille de Rochetaillée  
42000 Saint-Etienne - France

RCS Saint-Etienne B 338 002 231 | SAS au capital de 8 189 583 €

<https://www.sam-outillage.com/>

Photos and texts not contractually binding. Do not litter. Document generated on 2024-05-01 12:19:11





## DESCRIPTION

### Open wrenches in mm for micro-mechanics

2 heads of same opening, with 15 et 75°arc swing

a short handle and thin heads facilitate the delicate work for micro-mechanics, where the access to the nuts is difficult

## STANDARDS / DIRECTIVES

NF ISO 691, NF ISO 3318

### SAM Outillage

10 rue Camille de Rochetaillée  
42000 Saint-Etienne - France

RCS Saint-Etienne B 338 002 231 | SAS au capital de 8 189 583 €

<https://www.sam-outillage.com/>

Photos and texts not contractually binding. Do not litter. Document generated on 2024-05-01 12:19:11



SPECIFIC DATA

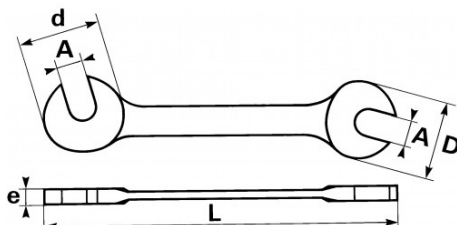

|                 |  |
|-----------------|--|
| Designation     | OFFSET O/E WRENCH OPEN MICRO MECHANICAL 55MM |
| Sales reference | 35-5,5                                       |
| L (mm)          | 75   |
| Weight (g)      | 9  |
| d (mm)          | 13   |
| e (mm)          | 2.4  |
| D (mm)          | 13   |
| A (mm)          | 5.5  |
| Guarantee       | O  |

**Guarantee applied**

**O | SAM TOOL guarantee.**

Guarantee without time limit on the tools used under normal conditions.

[>> Find out more](#)

**SAM Outillage**

10 rue Camille de Rochetaillée  
42000 Saint-Etienne - France

RCS Saint-Etienne B 338 002 231 | SAS au capital de 8 189 583 €

<https://www.sam-outillage.com/>

