



## Open wrenches in mm for micro-mechanics

**35-3,2**  
35-...

### SAM Outillage

10 rue Camille de Rochetaillée  
42000 Saint-Etienne - France

RCS Saint-Etienne B 338 002 231 | SAS au capital de 8 189 583 €

<https://www.sam-outillage.com/>

Photos and texts not contractually binding. Do not litter. Document generated on 2024-05-02 03:42:15





## DESCRIPTION

### Open wrenches in mm for micro-mechanics

2 heads of same opening, with 15 et 75° arc swing

a short handle and thin heads facilitate the delicate work for micro-mechanics, where the access to the nuts is difficult

## STANDARDS / DIRECTIVES

NF ISO 691, NF ISO 3318

### SAM Outillage

10 rue Camille de Rochetaillée  
42000 Saint-Etienne - France

RCS Saint-Etienne B 338 002 231 | SAS au capital de 8 189 583 €

<https://www.sam-outillage.com/>

Photos and texts not contractually binding. Do not litter. Document generated on 2024-05-02 03:42:15



SPECIFIC DATA

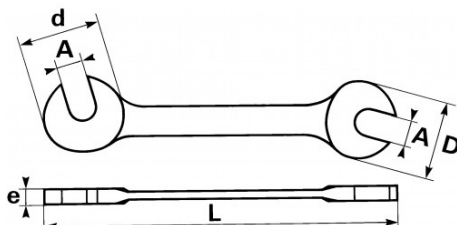

Designation	OFFSET O/E WRENCH OPEN MICRO MECHANICAL 32MM
Sales reference	35-3,2
L (mm)	70
Weight (g)	5
d (mm)	10
e (mm)	2.4
D (mm)	10
A (mm)	3.2
Guarantee	O

**Guarantee applied**

**O | SAM TOOL guarantee.**

Guarantee without time limit on the tools used under normal conditions.

[>> Find out more](#)

**SAM Outillage**

10 rue Camille de Rochetaillée  
42000 Saint-Etienne - France

RCS Saint-Etienne B 338 002 231 | SAS au capital de 8 189 583 €

<https://www.sam-outillage.com/>

