



## Open wrenches in mm for micro-mechanics

**35-15**  
35-...

### SAM Outillage

10 rue Camille de Rochetaillée  
42000 Saint-Etienne - France

RCS Saint-Etienne B 338 002 231 | SAS au capital de 8 189 583 €

<https://www.sam-outillage.com/>

Photos and texts not contractually binding. Do not litter. Document generated on 2024-05-02 01:21:19





## DESCRIPTION

### Open wrenches in mm for micro-mechanics

2 heads of same opening, with 15 et 75°arc swing

a short handle and thin heads facilitate the delicate work for micro-mechanics, where the access to the nuts is difficult

## STANDARDS / DIRECTIVES

NF ISO 691, NF ISO 3318

### SAM Outillage

10 rue Camille de Rochetaillée  
42000 Saint-Etienne - France

RCS Saint-Etienne B 338 002 231 | SAS au capital de 8 189 583 €

<https://www.sam-outillage.com/>

Photos and texts not contractually binding. Do not litter. Document generated on 2024-05-02 01:21:19



SPECIFIC DATA

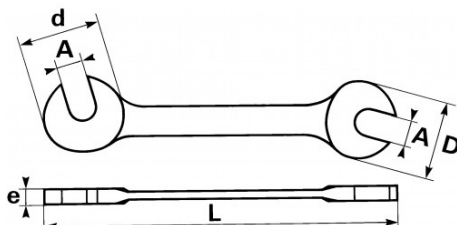

Designation	MICRO-MECHANICAL OPEN-END SPANNER 15 MM
Sales reference	35-15
L (mm)	139.4
Weight (g)	65
d (mm)	32.5
e (mm)	4.8
D (mm)	32.5
A (mm)	15
Guarantee	O

**Guarantee applied**

**O | SAM TOOL guarantee.**

Guarantee without time limit on the tools used under normal conditions.

[>> Find out more](#)

**SAM Outillage**

10 rue Camille de Rochetaillée  
42000 Saint-Etienne - France

RCS Saint-Etienne B 338 002 231 | SAS au capital de 8 189 583 €

<https://www.sam-outillage.com/>

